



TAI-SAW TECHNOLOGY CO., LTD.

No. 3, Industrial 2nd Rd., Ping-Chen Industrial District,
Taoyuan, 324, Taiwan, R.O.C.

TEL: 886-3-4690038 FAX: 886-3-4697532

E-mail: tstsales@mail.taisaw.com Web: www.taisaw.com

Approval Sheet For Product Specification

Issued Date:

Product Name: SAW Filter 427.8MHz SMD 5.0x5.0 mm

TST Parts No.:TA0527A

Customer Parts No.:_____

Company: _____
Division: _____
Approved by : _____
Date: _____

Checked by: _____ Elvis Chiu

Approval by: _____ Francis Chen

Date: _____ 2006/01/05



TAI-SAW TECHNOLOGY CO., LTD.

No. 3, Industrial 2nd Rd., Ping-Chen Industrial District,
Taoyuan, 324, Taiwan, R.O.C.

TEL: 886-3-4690038 FAX: 886-3-4697532

E-mail: tstsales@mail.taisaw.com Web: www.taisaw.com

SAW Filter 427.8 MHz

MODEL NO.: TA0527A

REV. NO.:1

A. MAXIMUM RATING:

1. Input Power Level: 10 dB_m
2. DC voltage: 3 V
3. Operating Temperature: +15°C to +35°C
4. Storage Temperature: -40°C to +85°C

RoHS Compliant
Lead free
Lead-free soldering

B. ELECTRICAL CHARACTERISTICS:

Balanced to Balanced operation

Terminating source impedance : Z_s = 200 Ω

Terminating load impedance : Z_L = 200 Ω

Item		Min.	Typical	Max.
Center frequency	F _c MH	-	427.8	-
Insertion loss	425.3 ~ 430.3 MHz IL	-	2.05	3.6
Amplitude ripple	425.3 ~ 430.3 MHz	-	0.65	2.1
VSWR	425.3 ~ 430.3 MHz	-	1.6	2.2
Attenuation (Reference level from 0 Db)				
1 ~ 391.0	MHz	40	55	-
391.0 ~ 406.5	MHz	31	56	-
406.5 ~ 417.9	MHz	10	40	-
461.0 ~ 481.0	MHz	35	60	-
481.0 ~ 555.0	MHz	40	62	-
Temperature coefficient of frequency	ppm/k	-	-36	-

C. FREQUENCY CHARACTERISTICS :

Transfer Function:

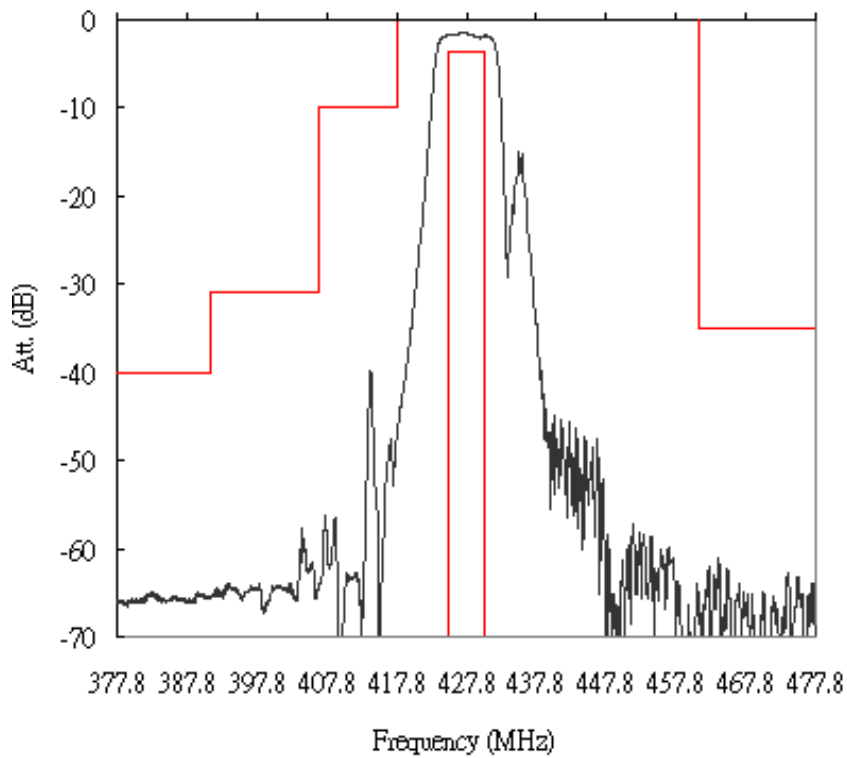
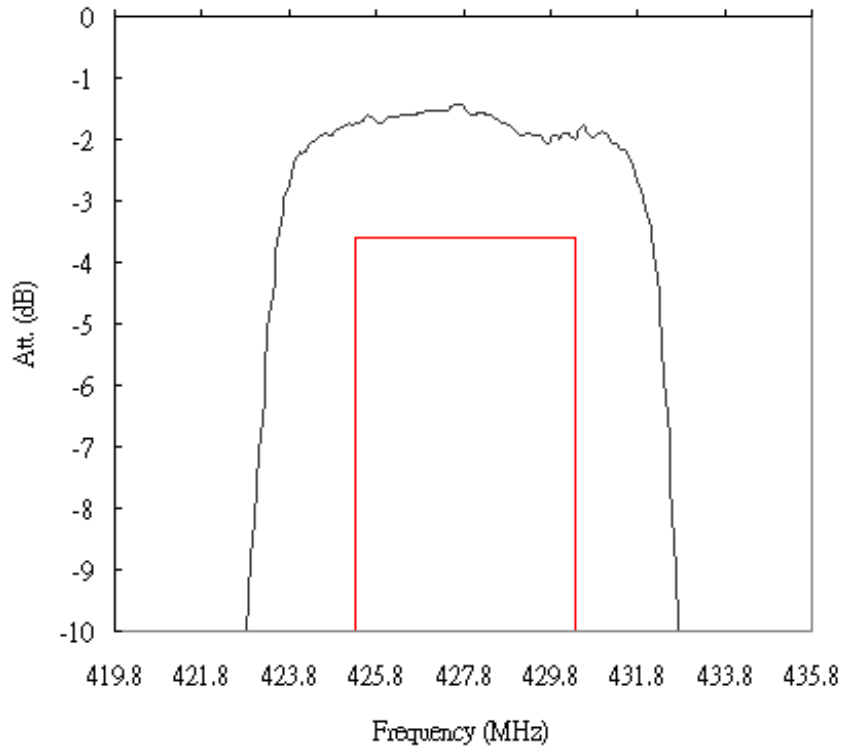

Reflection Function:

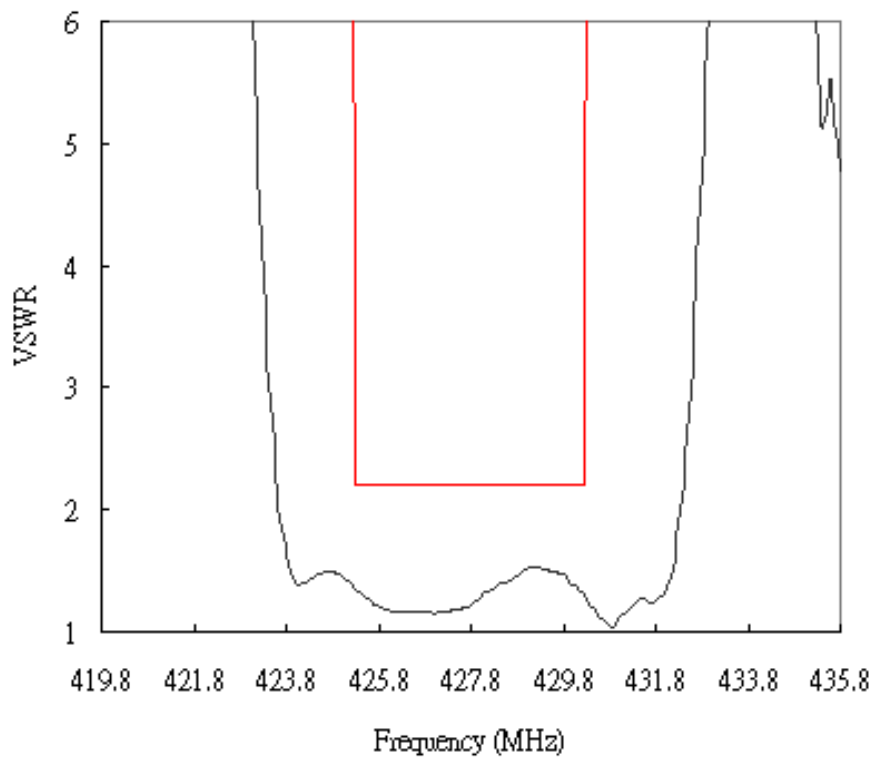
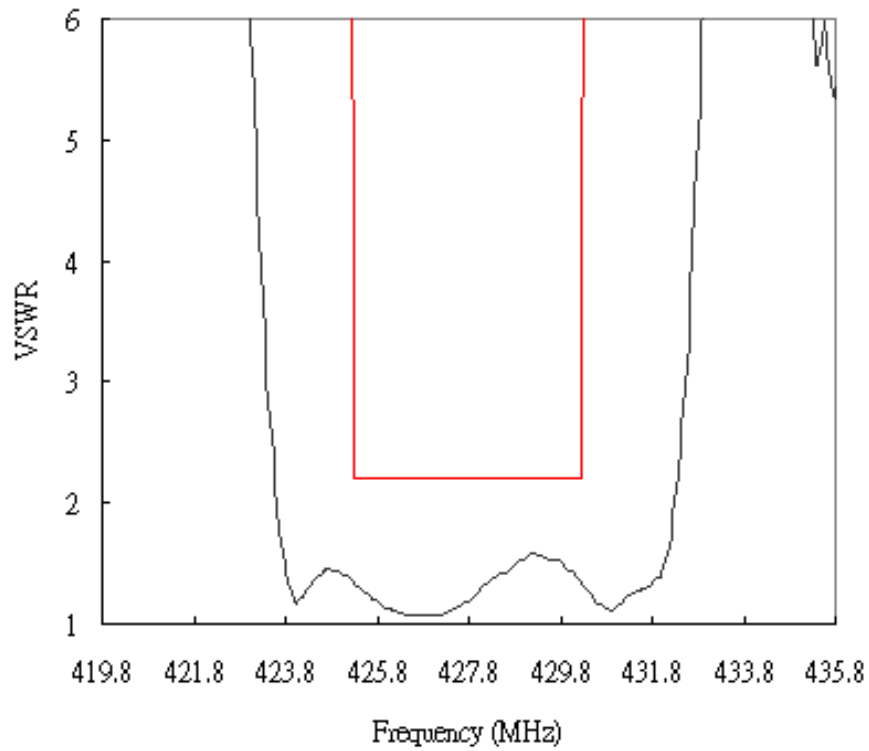

Wideband

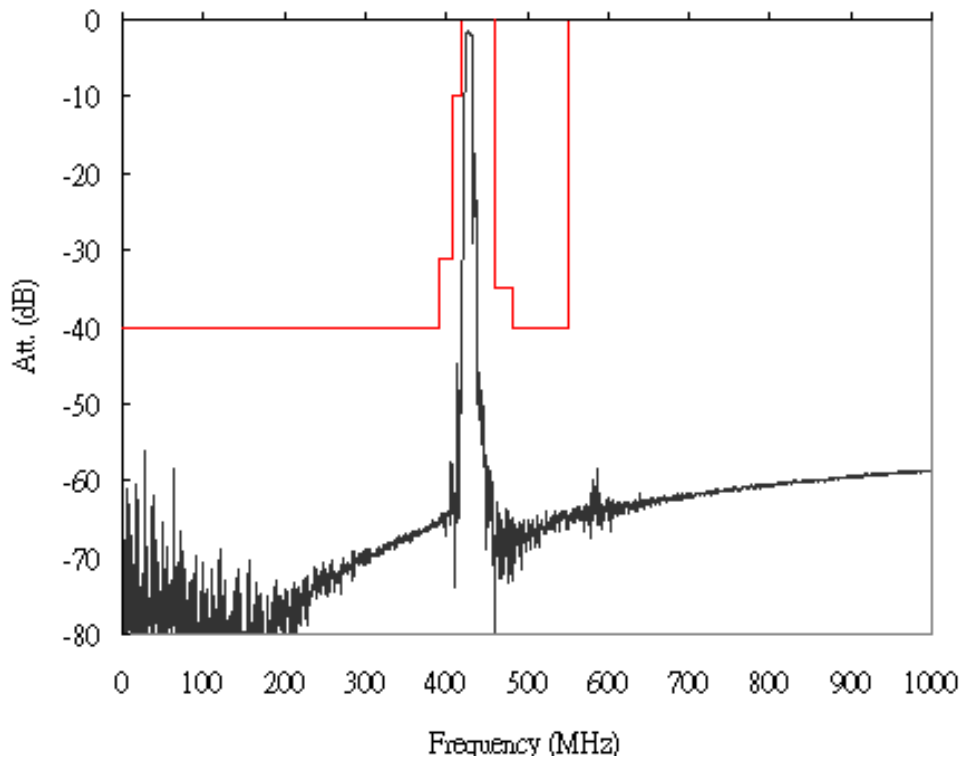

D. MEASUREMENT CIRCUIT:

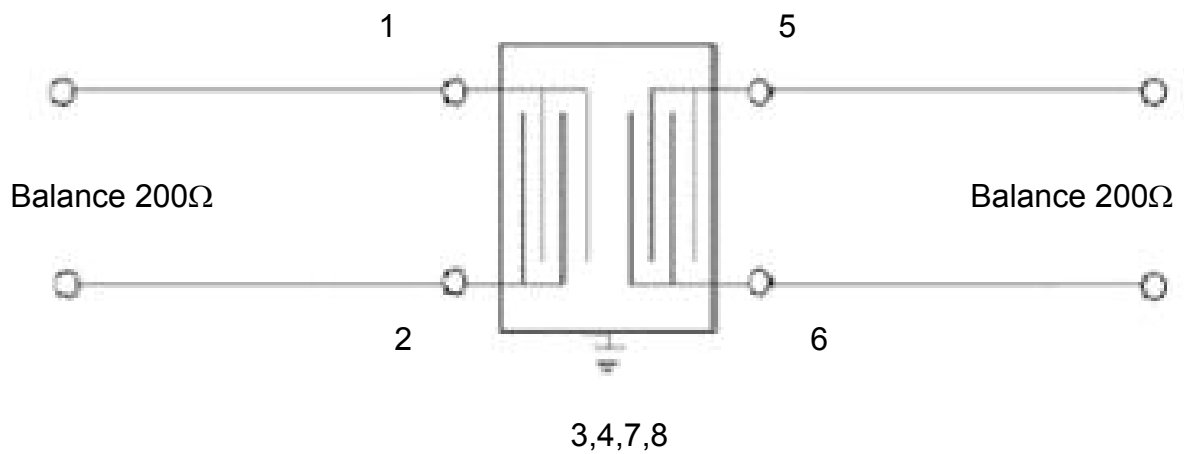

E. OUTLINE DRAWING:

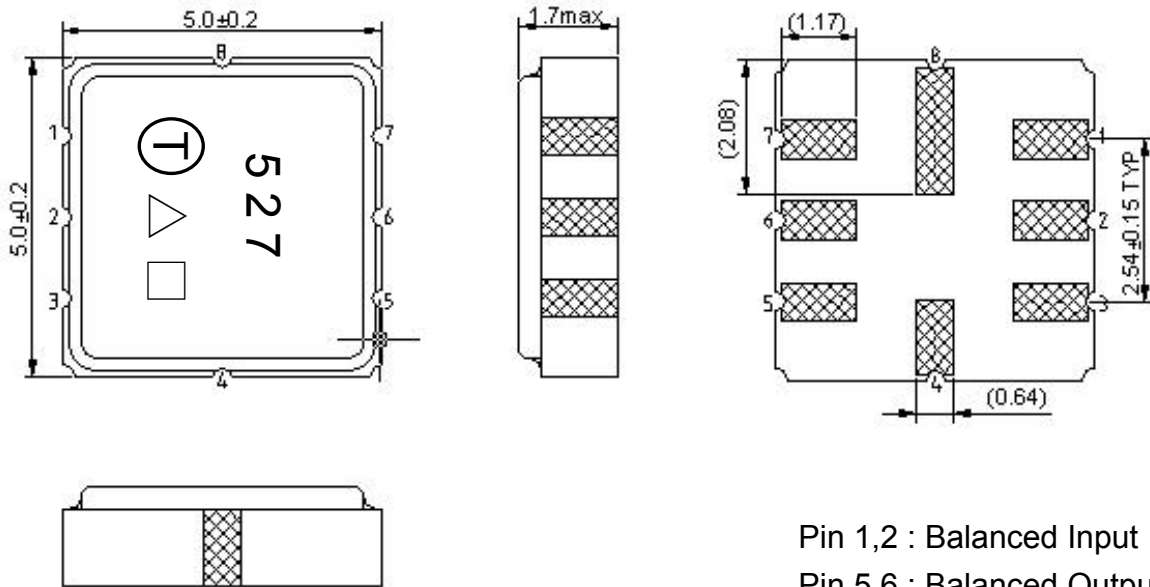

Pin 1,2 : Balanced Input
 Pin 5,6 : Balanced Output
 Pin 3,4,7,8 : Ground
 △ : Year Code
 □ : Date Code
 Unit : mm

Year	2001	2002	2003	2004
	2005	2006	2007	2008
Year Code	A	a	<u>A</u>	<u>a</u>

F. PCB FOOTPRINT:

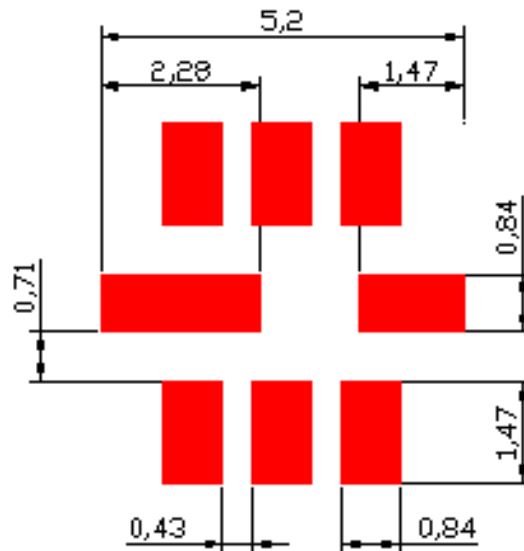

G. PACKING:

1. REEL DIMENSION

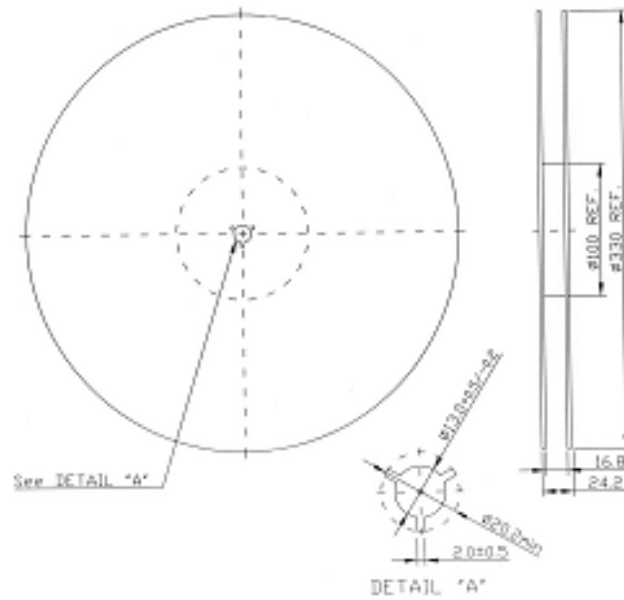

2. TAPE DIMENSION

